

Satu Bumi

Advanced Concrete Technology

Design Example

LED LIGHT GROOVE
- PLANTER



Artistic Impressions: Images and colours depicted are indicative only.

Satu Bumi Advanced Concrete Technology	3D Mark-Up	<u>Project Name:</u>	<u>Mark-up Reference:</u>	<u>Date:</u> 19/01/2024
--	---------------	----------------------	---------------------------	----------------------------

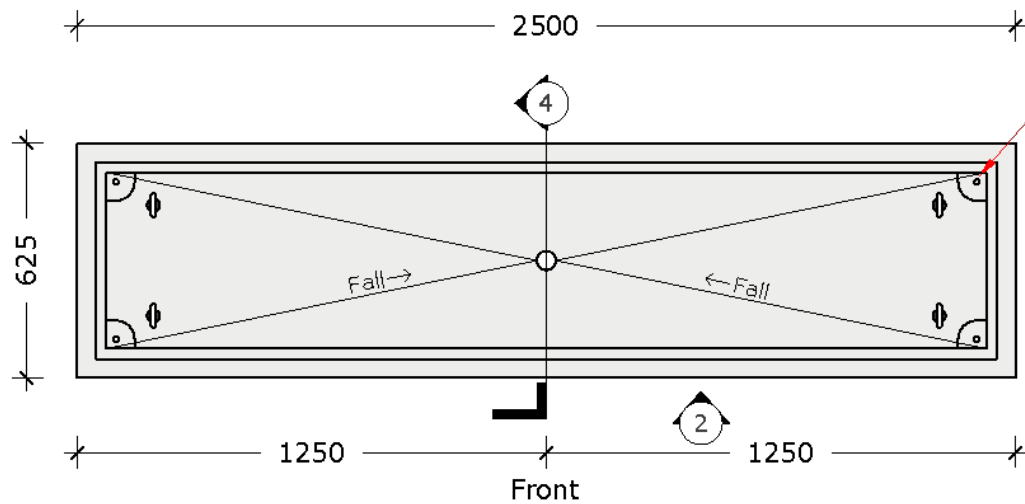

1 Plan View
Scale: 1 : 20

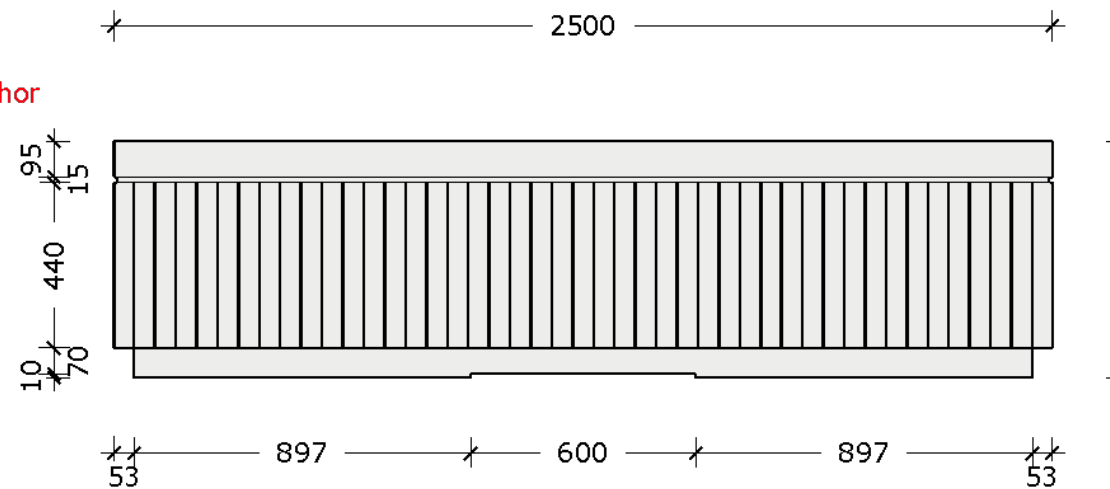

2 Front View
Scale: 1 : 20

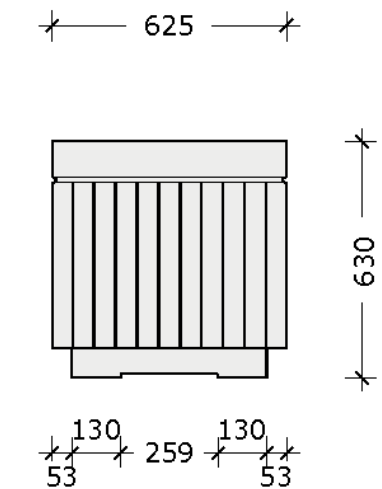

3 Side View
Scale: 1 : 20

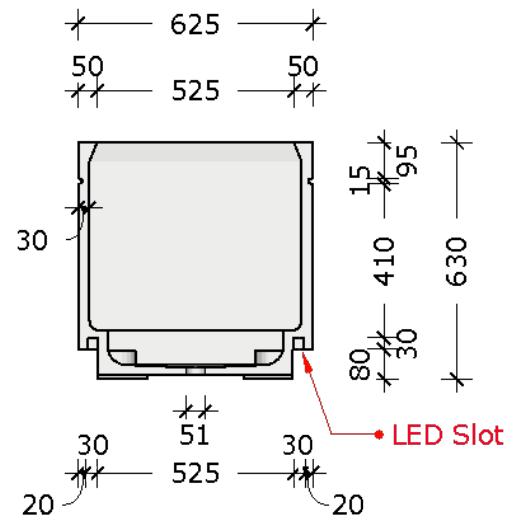

4 Section View
Scale: 1 : 20

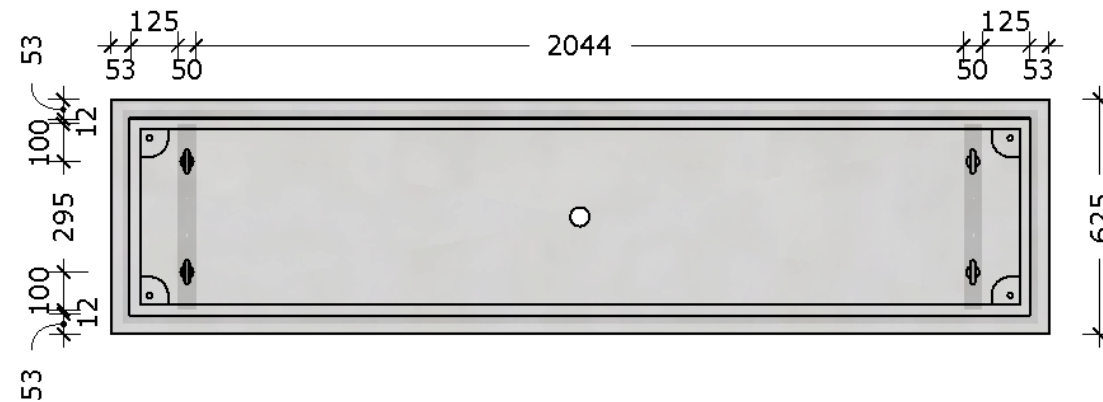

5 Lifting Lugs Scheme
Scale: 1 : 20

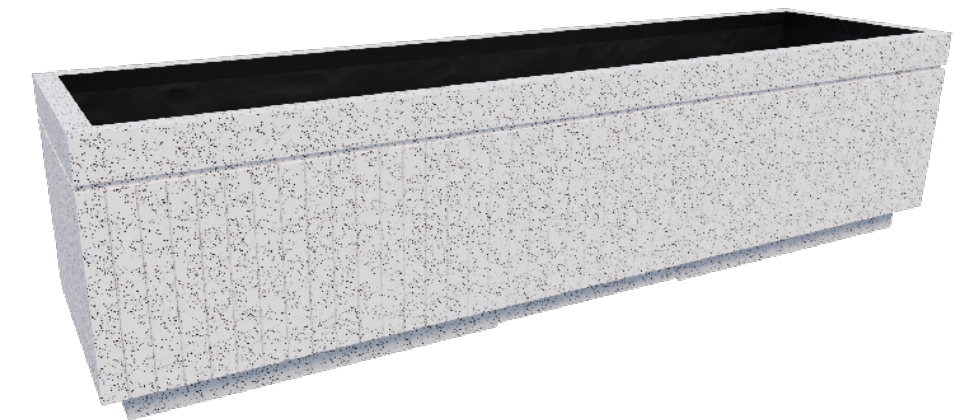

6 3D View
Not to Scale

Satu Bumi
Advanced Concrete Technology

Satu Bumi (Australia) Pty Ltd
ABN: 40 626 944 401
Phone: +61 (03) 5292 1001
Email: sales@satubumi.com.au
Web: www.satubumi.com.au

Project Name:

Product Code: PLANTER

Product Number:

Product Dimensions: 2500L x 625W x 630H*

Weight Estimate: 325 Kg

Order Quantity: -

Colour / Finish: Natural White / Aggregate

Internal Sealant: Bituminous Membrane

External Sealant: Penetrative Sealant

Lifting Lugs Certification: TBC

Drainage Riser: No

Additional Notes:

*Height includes feet

Customer Approval:

Drawn By:

PE Approved:

PROD Approved:

Scale: 1:20 @A3

Rev:

Date: 19/01/2024

Signature
Date:

This drawing remains the copyright of Satu Bumi (Australia) Pty. Ltd.

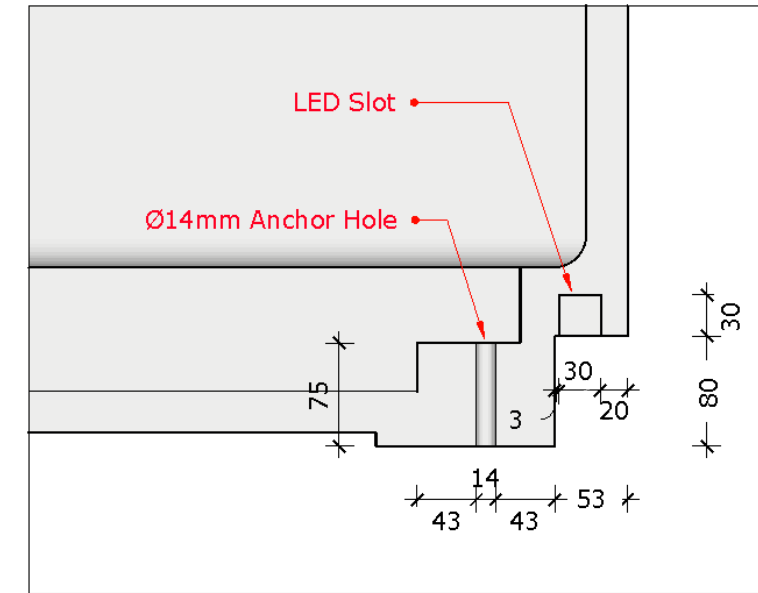

2 Zoomed View A
Scale: 1 : 5 @A3